

(PROJECT)

IMPROVING SUPPORTED HOUSING FOR PEOPLE WITH DISABILITY

KATE TREGLOAN
LIBBY CALLAWAY

THE INTERDISCIPLINARY IMPACT OF CREATIVE PRACTICE RESEARCH (SYMPOSIUM)

(VENUE)
MADA,
MONASH UNIVERSITY

26.09.2017



02.

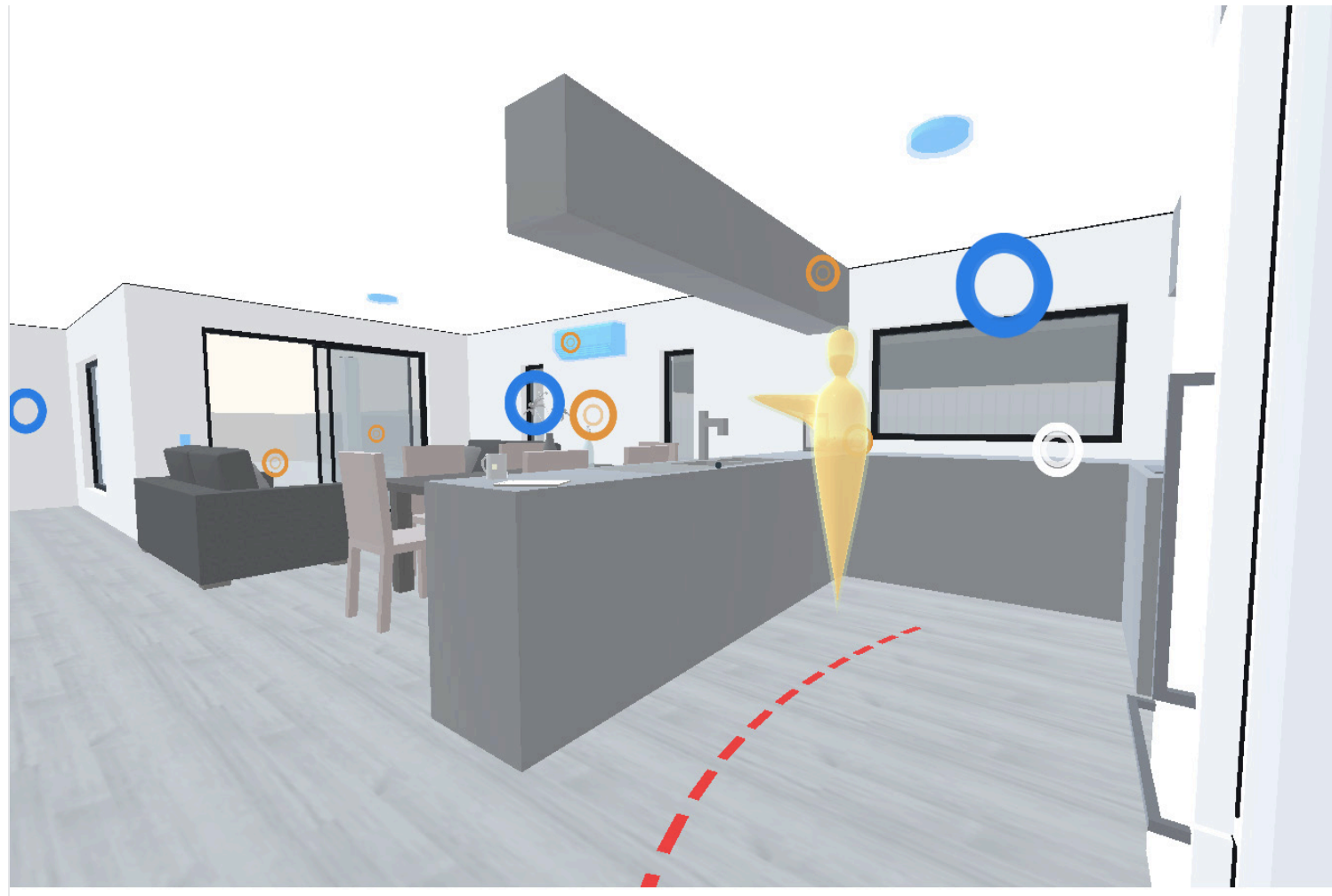

03.

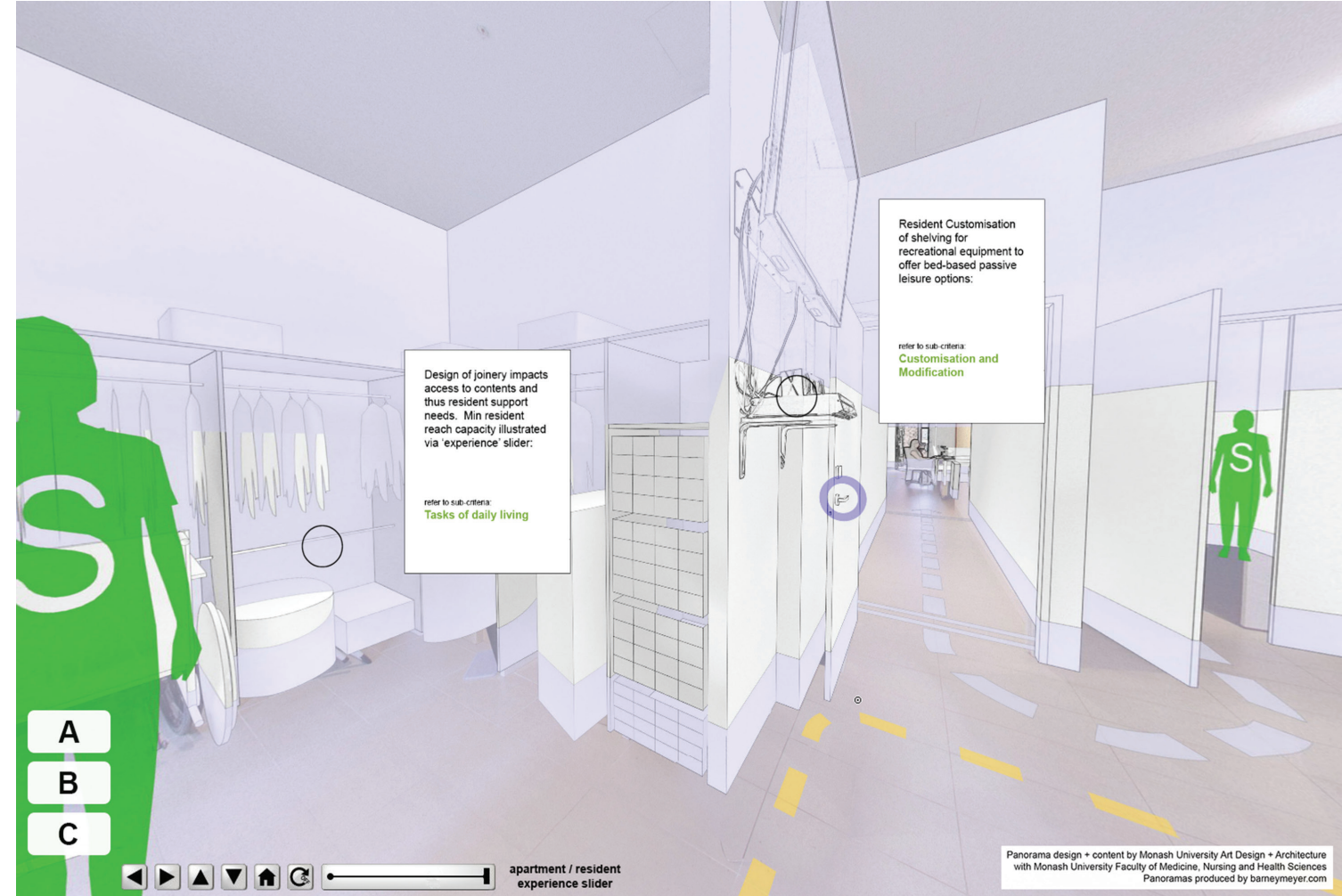

04.



05.

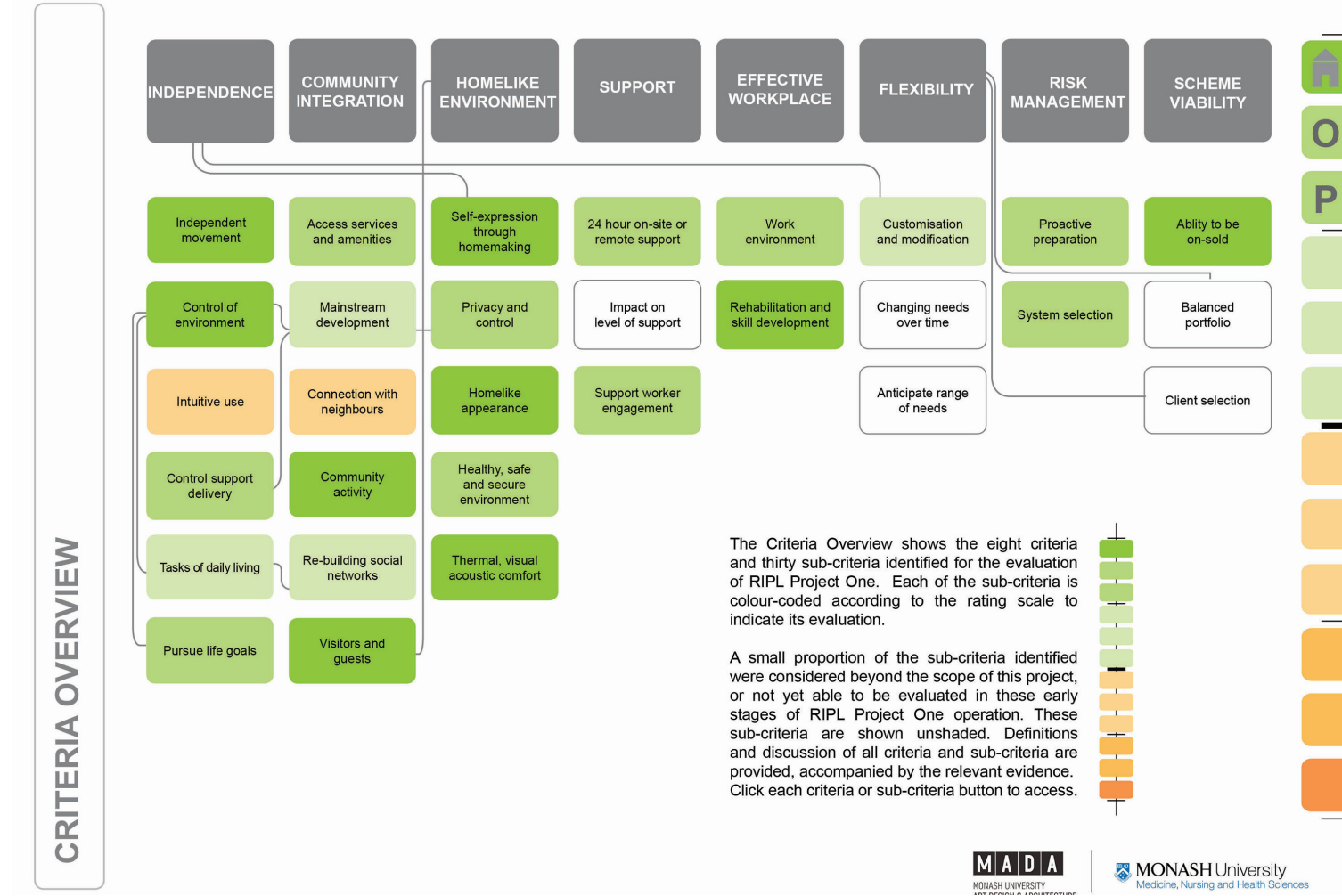

06.

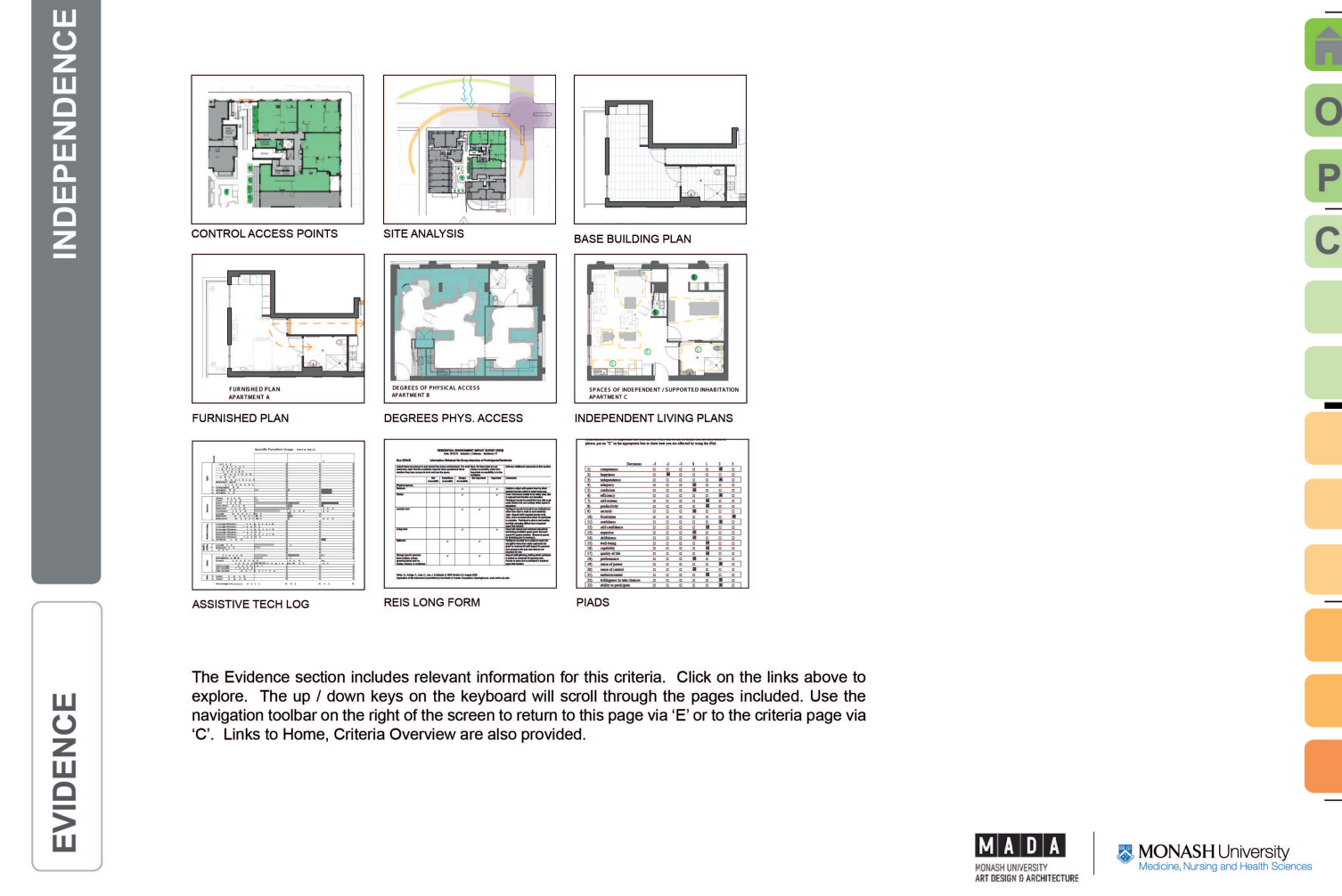

07.



08.

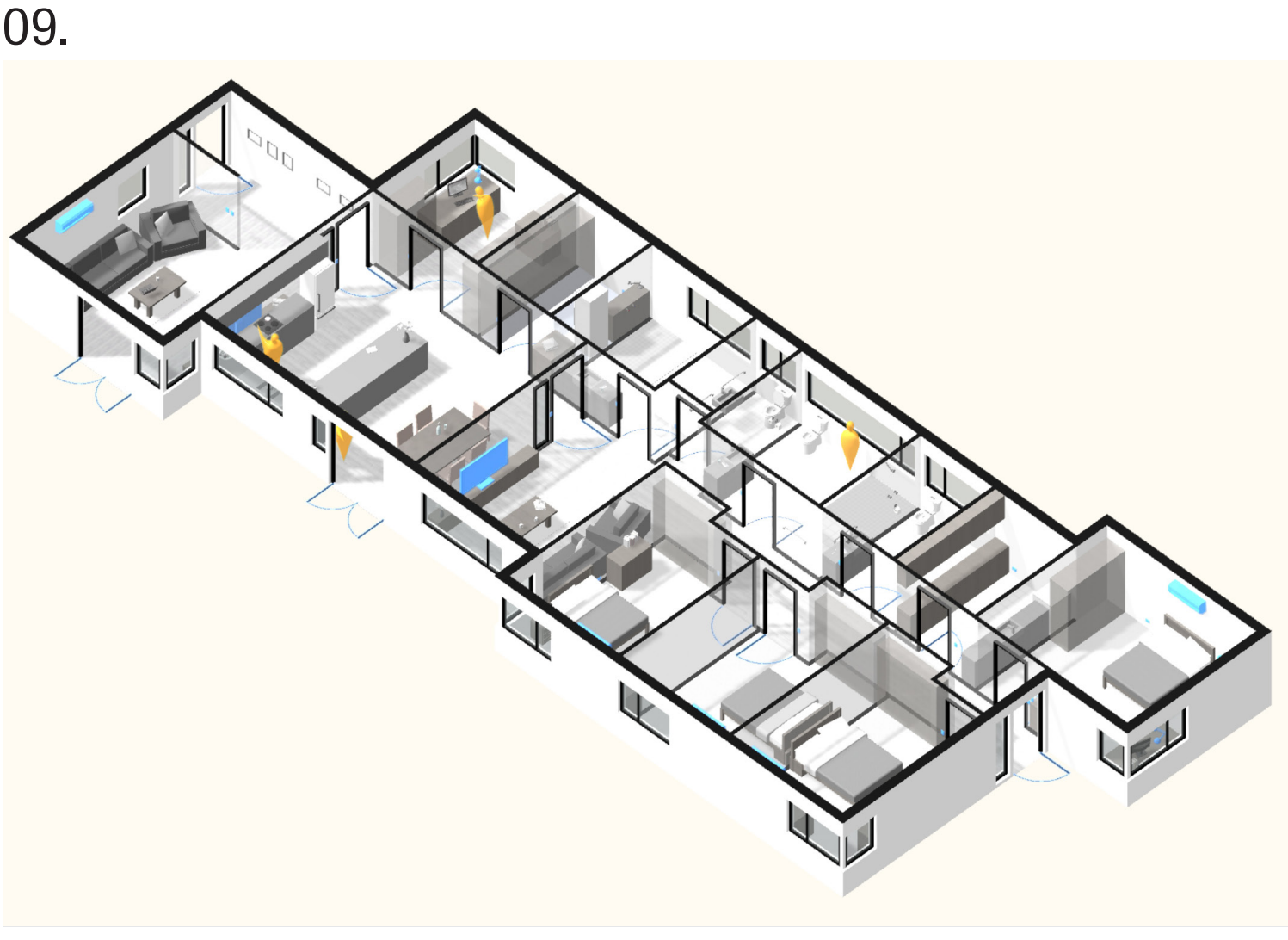

09.



10.



11.

- 01. Collaborative Project Mapping, Tregloan + Callaway et al, 2012 - 2018
- 02. RIPL Project 1 : panorama view
- 03. NDRD project : interior rail view
- 04. RIPL Project 1 : panorama view with slider
- 05. NDRD projec : interior detail view
- 06. RIPL projects : criteria overview
- 07. NDRD : project development sketch diagram
- 08. RIPL project : evidence / methodology mix
- 09. NDRD : assistive technology diagram
- 10. RIPL : mapping of reach and access
- 11. NDRD : group home model

INTER/DISCIPLINARY COMMUNICATIONS

Interdisciplinarity offers a move from discrete disciplines of knowledge, skillsets and perspectives (and the spaces between them), towards more complex and productive relationships in response to contemporary issues. The creative disciplines can offer particular approaches, expertise and facility to interdisciplinary research projects, to be balanced with those contributed by other cultures and epistemologies.

Interdisciplinary approaches offer “the emergence of insight and understanding of a problem domain through the integration ... of concepts, methods and epistemologies from different disciplines in a novel way” (Rogers, Scaife and Rizzo (2005) in Davies and Devlin, 2010). An interdisciplinary approach to practice or delivery recognises the importance of specific skills, but also aims to move beyond professional boundaries through trust, tolerance, shared responsibility and the development of a culture that supports collaborative practice (Orchard et al., 2005; Nolan, 1995). While offering a foundation for improved outcomes, interdisciplinary practice brings challenges for members who must “communicate, understand each other’s language, ideally develop a shared language, and learn to coordinate their actions as a team” (Newhouse and Spring, 2010).

A growing interdisciplinary team led by Tregloan and Callaway from Monash University Departments of Architecture and Occupational Therapy, has developed interdisciplinary, experience-focused methodologies to investigate supported housing models for people with disability. This long-running collaboration has relied on a nuanced engagement with the (expanding set of) methodologies of researchers’ home disciplines and the epistemologies and values they imply. This has expanded the overt and implicit languages employed in this shared undertaking, opening new ways of thinking, researching and making. Investigations have drawn on a mixed methods approach, balancing published measures and customized tactics that draw on professional conventions.

Methodology and findings from initial projects, commissioned by the Transport Accident Commission in Victoria to evaluate supported housing models, have been extended. These more recent projects have been funded by State and Federal Government and build government and industry partnerships for Monash across multiple states. The team’s interdisciplinary work has informed ongoing government investment and design.

Project findings are presented in interactive pdf reports that draw on designerly skillsets for the communication of networked evidence. The research

team also designed and produced innovative navigable panoramas to represent occupied spaces with situated research findings, bringing together detailed analysis and spatial experiences. This work was one of five international projects to receive an award recognising Research Excellence by the US Environment Design Research Association in 2015. Dissemination activities have addressed disciplinary, interdisciplinary, academic, government and commercial audiences.

The interdisciplinary research team was awarded one of nine national grants as part of the second implementation phase of Australia’s ten year National Disability Strategy. The National Disability Research and Development (NDRD) project is investigating the current delivery phase of Specialist Disability Accommodation within the new \$22B National Disability Insurance Scheme (NDIS). A national review of supported housing has expanded these interdisciplinary collaborations, the range of models investigated, and stakeholders to include government and housing providers. Outcomes will include an interactive gamespace that will translate current NDIS and government policies and rules for a range of stakeholders to support design and decision-making.

These and other research outcomes offer valuable educative resources for health and design professionals, developers and support providers, and for people living with disabilities and their families. Further development of professional skills for delivery of supported accommodation to people with disability within the NDIS is building on this work in turn, and includes new projects with a focus on educational design and delivery.

This suite of work highlights the value of the creative disciplines to interdisciplinary research, by bringing developed disciplinary skillsets to engage with complex problems. It also highlights the value of the conventions of architectural representation for effective communication, and potential expansion of non-traditional research outputs for the dissemination and impact of research findings. It reminds us of the need for a collaborative research approach that accommodates multiple ways to speak and also to be heard.

- 1. Davies M and Devlin M. (2010) Interdisciplinary Higher Education. In: Davies M, Devlin M and Tight M (eds) Interdisciplinary Higher Education: Perspectives and Practicalities. Bingley: Emerald House Publishing, 3-28.
- 2. Klein JT. (2008) Evaluation of Interdisciplinary and Transdisciplinary Research - A Literature Review. American Journal of Preventative Medicine 35: S116-S123.
- 3. Nolan M. (1995) Towards an ethos of interdisciplinary practice. British Medical Journal 311: 305-307.
- 4. Newhouse R and Spring B. (2010) Interdisciplinary evidence-based practice: moving from silos to synergy. Nursing Outlook 58: 309-317.
- 5. Orchard C, Curran V and Kabene S. (2005) Creating a Culture for Interdisciplinary Collaborative Professional Practice. Medical Education Online.